



Spare part available:  
Hand Torch Tip 10 mm  
Part No: SPBTT1



Portable brazing and heating torches are an essential item for plumbing, HVAC-R and service industry technicians for many applications. Designed to fit directly to a Flame Pro<sup>®</sup> or equivalent cylinder, the Tesuco<sup>®</sup> hand brazing torch comes with piezo auto-ignite functionality. With a plastic handle and a stainless steel barrel and brass tip, it is durable and reliable. The swirl flame tip gives a stable flame in the wind, better combustion and an expanded heat zone with a flame temperature using the Flame Pro<sup>®</sup> gas of up to approximately 1450°C.

### FEATURES

- High intensity swirl flame.
- 360° Swivel stainless steel necktube, suitable for difficult positions.
- Quick locking nut connection.
- CGA600 inlet connection suitable for propane and MAPP type gases.
- Control valve for adjustable flame.
- Comfortable handle design.
- Trigger locking button.
- Piezo ignition trigger.

### SPECIFICATIONS

### GBTP

SPECIFICATIONS	GBTP
<b>Packaging type</b>	Hangsell display
<b>Materials of construction</b>	
Handle	Plastic
Barrel	Stainless steel
Nozzle	Brass
Seal	NBR 70
<b>Inlet connection</b>	CGA 600
<b>Dimensions (mm)</b>	
Product only	(H) 280 x (W) 135 x (D) 40
With packaging	(H) 380 x (W) 170 x (D) 55
<b>Weight</b>	
Nett	0.53 kg
Gross	0.69 kg
<b>Warranty</b>	3 Year limited (Manufacturer's defect)
<b>Country of origin</b>	China

**FLAME PRO**<sup>®</sup>



Flame Pro<sup>®</sup> is a fuel gas in a disposable cylinder. It is designed for use with the Turbo Set 200, which is aimed at the plumbing, air conditioning, refrigeration and other professional trades markets. With oxygen, it has a flame temperature in excess of 3,000°C, making it ideal for many applications requiring a higher temperature than LpG on its own.

**SPECIFICATIONS**

**GTFP**

SPECIFICATIONS	GTFP
Materials of construction	Steel
Operating temperature	Not to Exceed +49°C
DG classification	2.1
Outlet connection	CGA 600
Warranty	1 Year (Manufacturer's defect)
Country of origin	USA

**FLAME HEAT GUARD**

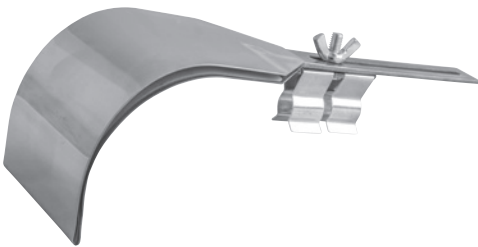

**FEATURES**

- Stainless steel construction with adjustable arm for protection of the surrounding area.
- Helps prevent heat damage.
- Fits GBTP torches and other brands.



**PART NO.**

**GBTPHG**